



Caution

Do not mark on the product and its components with a pen or allow printed materials to come in contact with the surface. Ink marks cannot be removed.

MW64

Vaccination Training Set (Set of 5/Set of 1)

Instruction
Manual

Content



- Features P. 1
- Before you start P. 2
- Preparation P. 3
- Training P. 4
- Replacing consumables P. 5

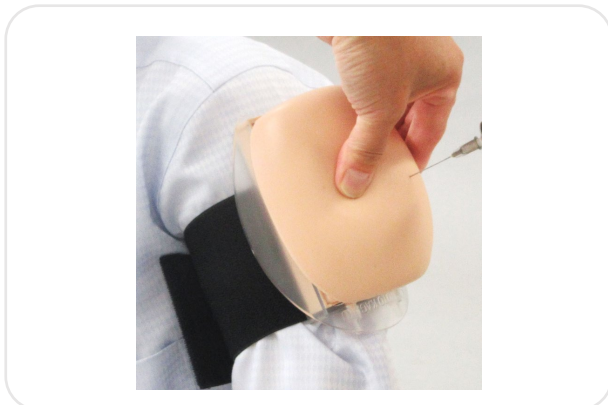

Before using

Features

Before using

The simulator is designed for training in deltoid IM injection. Do not use for it for any other purpose. Please read the instruction carefully before use.

features

- It can be attached to the upper arm of an SP(Simulated Patient) or full-body training manikin for realistic practice of intramuscular injection.
- The injection pad has a highly absorbent sponge built in, so that you can actually inject the liquid repeatedly.
- The landmark acromion process is palpable, allowing for realistic practice of IM injection.

DOs and DON'Ts

DOs

The materials for the product are special compositions of soft and hard resin.

Please handle them with the utmost care at all times. Store the training set at room temperature, away from heat, moisture and direct sunlight.

DON'Ts

Never wipe the product with thinner or organic solvent.

Don't mark on the product with pen or leave any printed materials in contact with their surface. Ink marks cannot be wiped out.

Set includes

Before your first using, ensure that all components listed below are included.

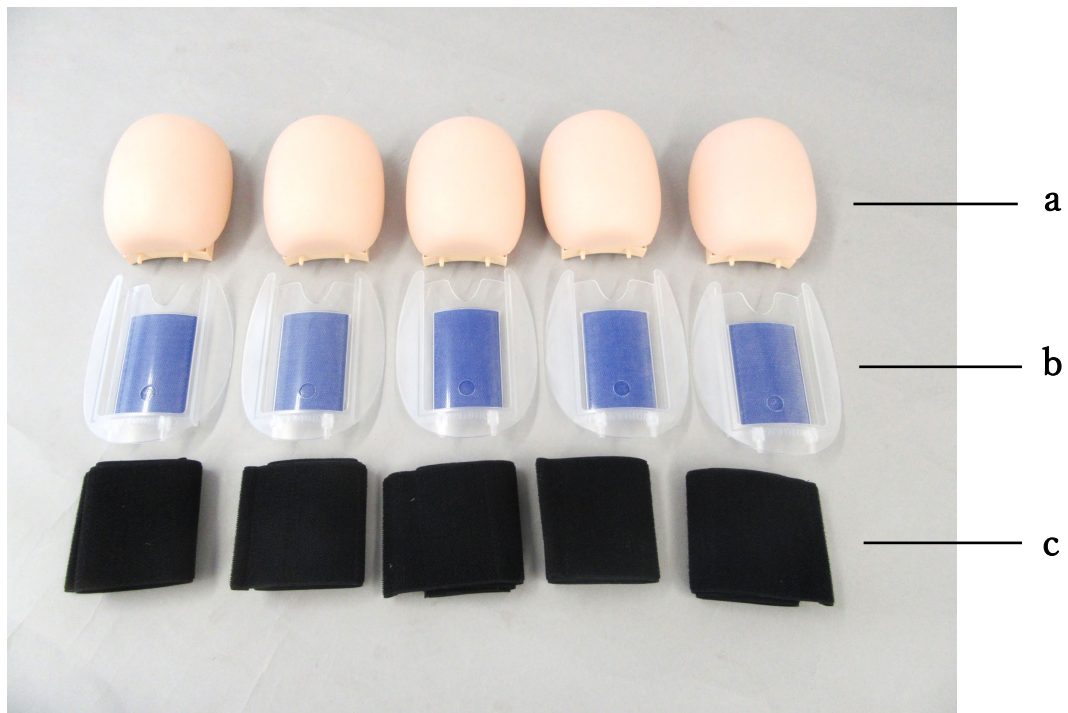

- a. Puncture Pad 5
 - b. Pad holder 5
 - c. Strap belt..... 5
- Instruction manual

※ In case of the Set of 1, the number of a,b, and c is 1.

Attaching the pad

1. Wrap the strap belt

Wrap the strap belt around the site on the arm/hand for training.

The Velcro on the front side of the belt is concave on all sides and can be fastened in any place.



2. Fix the pad holder to the strap belt

Fix the pad to the strap belt.

The back of the pad holder has area of the Velcro. By just putting the pad holder on the strap belt, the pad is fixed at any site on the belt.

The injection pad is designed to allow for palpation of the acromion process. Pay attention to the vertical orientation of the pad (as shown below). For a realistic practice, be aware of the position of the acromion process when wearing it.

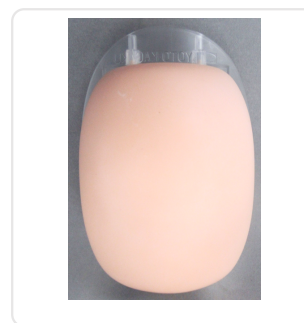

Training

Training procedure and notes

Training

The feel of the acromion process allows for confirmation of the puncture site. It is possible to actually inject the liquid. The injected liquid is absorbed by the sponge inside.

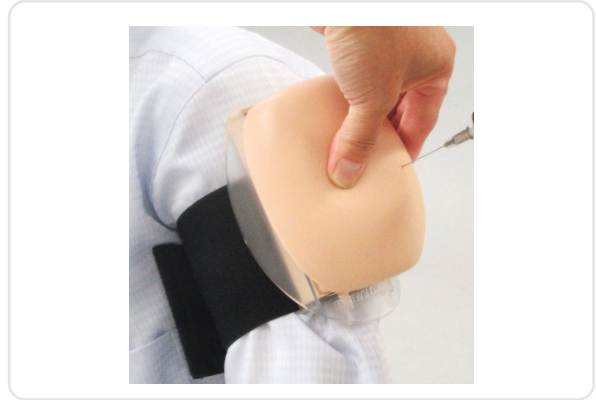

After training

After training

After training

Remove the pad from the belt and slide the injection pad off the pad holder.

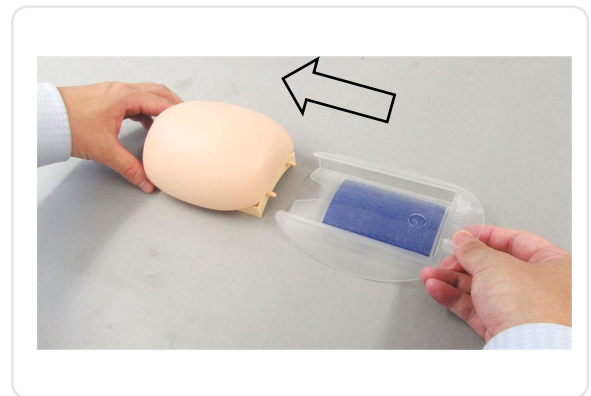

Squeeze the pad by holding its back side and pressing from the front side. The water will drain out through the hole on the back of the pad. The draining process should be done over a sink.



Replacing consumables

1. Replacement of injection pads

Pull out the pad from the frame.

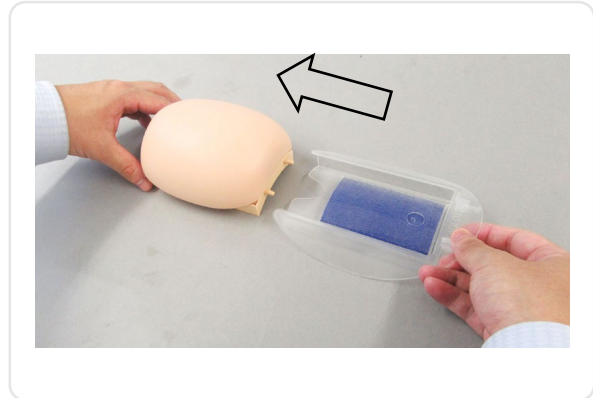

2. Attaching the injection pad

Slide a new puncture pad into the lane of frame.

When doing this, be careful to keep the two prongs on the side of the pad facing the pad holder.

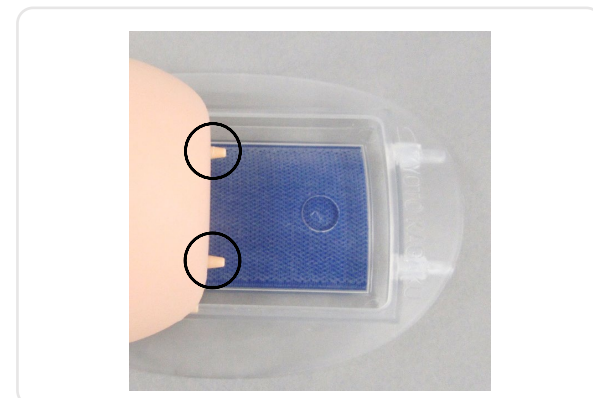
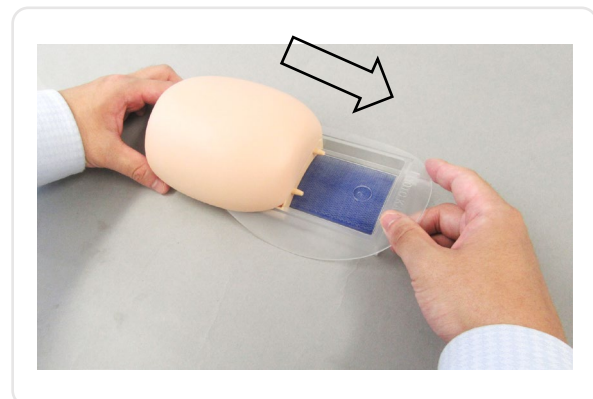

Consumable

| Code | Name |
|-----------|--|
| 11454-010 | MW64 Pad for Vaccination Training Set (Set of 5) |
| 11454-020 | MW64 Pad for Vaccination Training Set |



11454-010
MW64 Pad for Vaccination Training
Set (Set of 5)



11454-020
MW64 Pad for Vaccination
Training Set



注意

モデル表面に印刷物などが直接触れないようにしてください。
樹脂にインクが吸収されて消えなくなります。



Caution

Do not let ink from pens, newspapers, product manual or other sources contact the manikin. Ink marks on the manikin will be irremovable.

- 本製品についてのお問い合わせや不具合等ございましたら、お手数ですがお買い上げの販売店、もしくは下記 (株)京都科学まで御連絡ください。
- For inquiries and service, please contact your distributor or KYOTO KAGAKU CO., LTD.



URL・<http://www.kyotokagaku.com> e-mail・rw-kyoto@kyotokagaku.co.jp

■ 本社・工場

〒612-8388 京都市伏見区北寝小屋町15番地
TEL: 075-605-2510 (直通)
FAX: 075-605-2519

■ 東京支店

〒113-0033 東京都文京区本郷三丁目26番6号
NREG本郷三丁目ビル2階
TEL: 03-3817-8071 (直通)
FAX: 03-3817-8075

■ Main Office and Factory (World Wide)



WEB・www.kyotogagaku.com

E-MAIL・rw-kyoto@kyotokagaku.co.jp

15 kitanechoya-cho Fushimi-ku Kyoto 612-8388, Japan
TEL: +81-75-605-2510
FAX: +81-75-605-2519

■ North and South American regions:



WEB・www.kkamerica-inc.com

E-MAIL・info@kkamerica-inc.com

3109 Lomita Boulevard, Torrance, CA 90505-5108, USA
TEL: +1-310-325-8860
(Toll-free in North America: 877-648-8195)
FAX: +1-310-325-8867

本書の内容は、予告なしに変更することがあります。本書の内容の一部もしくは全部を当社に無断で複写・転載することを禁じます。

本書の内容に、万一不審な点や誤りなど、お気づきの点がございましたら、当社もしくは販売店にご連絡ください。

The contents of the instruction manual are subject to change without prior notice.

No part of this instruction manual may be reproduced or transmitted in any form without permission from the manufacturer.

Please contact manufacturer for extra copies of this manual which may contain important updates and revisions.

Please contact manufacturer with any discrepancies in this manual or product feedback. Your cooperation is greatly appreciated.